

CONNECTING A NEW NEIGHBOURHOOD

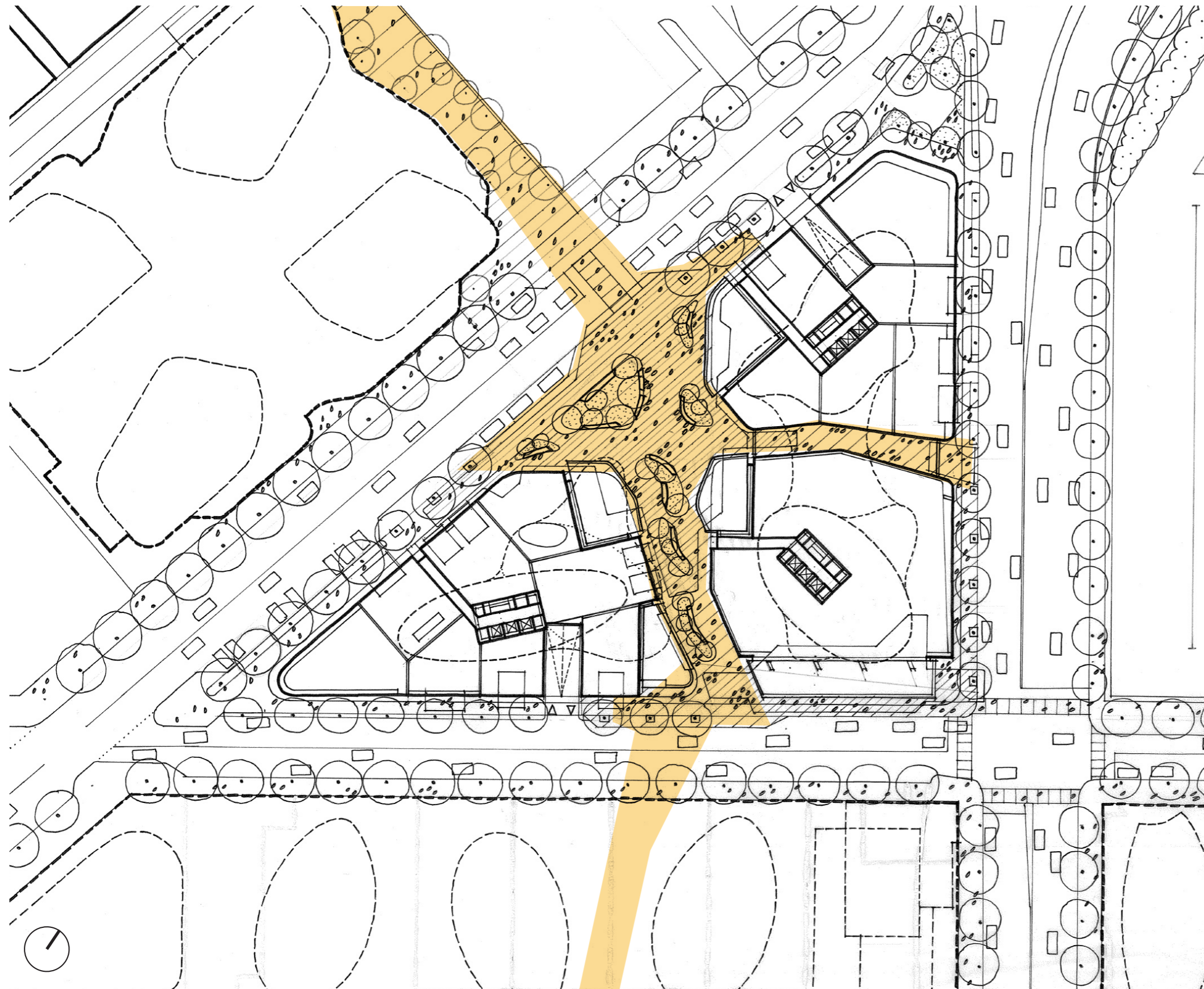

3.1 CONNECTING A NEW NEIGHBOURHOOD



An activated ground plane and podiums with integrated public amenity and highly transparent retail provisions will create an inviting and lively interface for the broader South Melbourne area.

Permeability through the site is provided through activated public space and internal lane-way environments fronted primarily with active and transparent edges. Opportunities for integration with the aspirations of the Fishermans Bend Strategic Framework are created through an emphasis on quality public space that serves as a focal point for the development and its surrounds.

Ease of public passive surveillance and universal accessibility will ensure a safe and lively environment for enjoyment not only by staff and residents but also by visitors and the broader South Melbourne community.